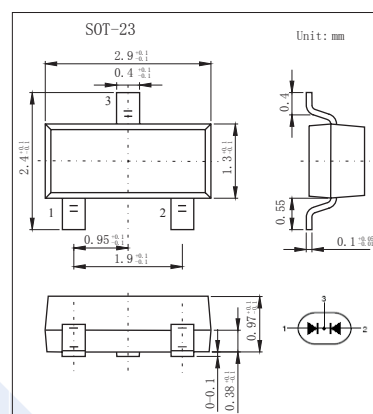

Switching Diodes

KDS184-HF

■ Features

- Small Package
- Low forward voltage : $V_{F(3)} = 0.9\text{ V(Typ.)}$
- Fast Reverse Recovery Time : $t_{rr} = 1.6\text{ ns(Typ.)}$
- Small Total Capacitance : $C_T = 0.9\text{ pF(Typ.)}$
- Pb-Free Package May be Available. The G-Suffix Denotes a Pb-Free Lead Finish

■ Absolute Maximum Ratings $T_a = 25^\circ\text{C}$

| Parameter | Symbol | Rating | Unit |
|----------------------------------|-----------|------------|------------------|
| Peak Reverse voltage | V_{RM} | 85 | V |
| DC Blocking Voltage | V_R | 80 | |
| Average Rectified Output Current | I_o | 100 | mA |
| Peak forward surge current | I_{FM} | 300 | |
| Power Dissipation | P_D | 150 | mW |
| Junction Temperature | T_J | 125 | $^\circ\text{C}$ |
| Storage temperature range | T_{stg} | -55 to 150 | |

■ Electrical Characteristics $T_a = 25^\circ\text{C}$

| Parameter | Symbol | Test Conditions | Min | Typ | Max | Unit |
|---------------------------------|----------|--------------------------------------|-----|------|-----|---------------|
| Reverse breakdown voltage | V_R | $I_R = 100\text{ }\mu\text{A}$ | 80 | | | V |
| Forward voltage | V_{F1} | $I_F = 1\text{ mA}$ | | 0.6 | | |
| | V_{F2} | $I_F = 10\text{ mA}$ | | 0.72 | | |
| | V_{F3} | $I_F = 100\text{ mA}$ | | 0.9 | 1.2 | |
| Reverse voltage leakage current | I_{R1} | $V_R = 30\text{ V}$ | | | 0.1 | μA |
| | I_{R2} | $V_R = 80\text{ V}$ | | | 0.5 | |
| Capacitance between terminals | C_T | $V_R = 0\text{ V}, f = 1\text{ MHz}$ | | 0.9 | 3 | pF |
| Reverse recovery time | t_{rr} | $I_F = 10\text{ mA}$ | | 1.6 | 4 | ns |

■ Marking

| | |
|---------|------|
| Marking | B3 F |
|---------|------|

Switching Diodes

KDS184-HF

■ Typical Characteristics

