

## Schottky Diodes

### BAT54/A/C/S (KAT54/A/C/S)

#### ■ Features

- Low forward voltage
- Guard ring protected
- Small plastic SMD package.

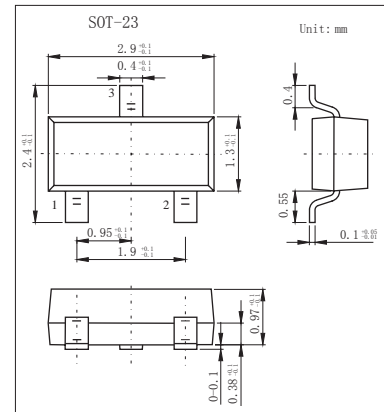
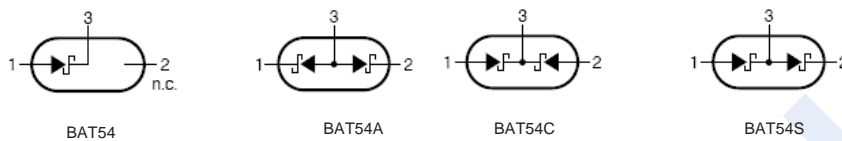

#### ■ Absolute Maximum Ratings $T_a = 25^\circ\text{C}$

| Parameter   | Symbol          | Rating      | Unit                      |
|---|-----------------|-------------|---------------------------|
| Maximum Repetitive Reverse Voltage                                    | $V_{RRM}$       | 30          | V                         |
| Average Rectified Forward Current                                     | $I_{F(AV)}$     | 200         | mA                        |
| Non-repetitive Peak Forward Surge Current<br>Pulse width = 1.0 second | $I_{FSM}$       | 600         | mA                        |
| Power Dissipation   | $P_D$           | 200         | mW                        |
| Thermal Resistance, Junction to Ambient                               | $R_{\theta JA}$ | 430         | $^\circ\text{C}/\text{W}$ |
| Storage Temperature Range   | $T_{stg}$       | -55 to +150 | $^\circ\text{C}$          |
| Operating Junction Temperature  | $T_J$           | 150         | $^\circ\text{C}$          |

#### ■ Electrical Characteristics $T_a = 25^\circ\text{C}$

| Parameter             | Symbol   | Testconditions   | Min | Typ | Max | Unit          |
|-----------------------|----------|--|-----|-----|-----|---------------|
| Breakdown Voltage     | $V_R$    | $I_R = 100 \mu\text{A}$  | 30  |     |     | V             |
| Forward Voltage       | $V_F$    | $I_F = 0.1 \text{ mA}$   |     |     | 240 | mV            |
|                       |          | $I_F = 1 \text{ mA}$   |     |     | 320 | mV            |
|                       |          | $I_F = 10 \text{ mA}$  |     |     | 400 | mV            |
|                       |          | $I_F = 30 \text{ mA}$  |     |     | 500 | mV            |
|                       |          | $I_F = 100 \text{ mA}$   |     |     | 0.8 | V             |
| Reverse Current       | $I_R$    | $V_R = 25 \text{ V}$   |     |     | 2   | $\mu\text{A}$ |
| Total Capacitance     | $C_T$    | $V_R = 1 \text{ V}, f = 1.0 \text{ MHz}$                               |     |     | 10  | pF            |
| Reverse Recovery Time | $t_{rr}$ | $I_F = I_R = 10 \text{ mA}, I_{RR} = 1.0 \text{ mA}, R_L = 100 \Omega$ |     |     | 5   | ns            |

#### ■ Marking

| TYPE    | BAT54     | BAT54A     | BAT54C     | BAT54S     |
|---------|-----------|------------|------------|------------|
| Marking | L4 or L4P | L42 or KL2 | L43 or KL3 | L44 or KL4 |

**BAT54/A/C/S (KAT54/A/C/S)**

■ Typical Characteristics

